

Fontvieille – Large family apartment with terrace, panoramic sea view, two parking spaces and cellar

Rental Monaco

38 000 € / month

+ Service charges : 3.800 €

Fontvieille – Elegant family apartment with terrace and panoramic sea view, two parking spaces and cellar

Product type	Apartment	Num rooms	4
Total area	281 m ²	Num bedrooms	3
Living area	212 m ²	Num parking	2
Terrace area	69 m ²	Num cellars	1
View	panoramic sea	Building	Memmo Center
Exposure	South West	District	Fontvieille
Condition	Luxurious amenities	Floor	8
Release date	01/08/2026		

Large apartment ideal for a family. Composed of: large entrance, guest toilet, living room opening onto a terrace with panoramic sea view, fitted kitchen, 3 bedrooms with 3 bathrooms.

Two parking spaces and a cellar



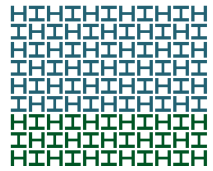

Fontvieille – Large family apartment with terrace, panoramic sea view, two parking spaces and cellar

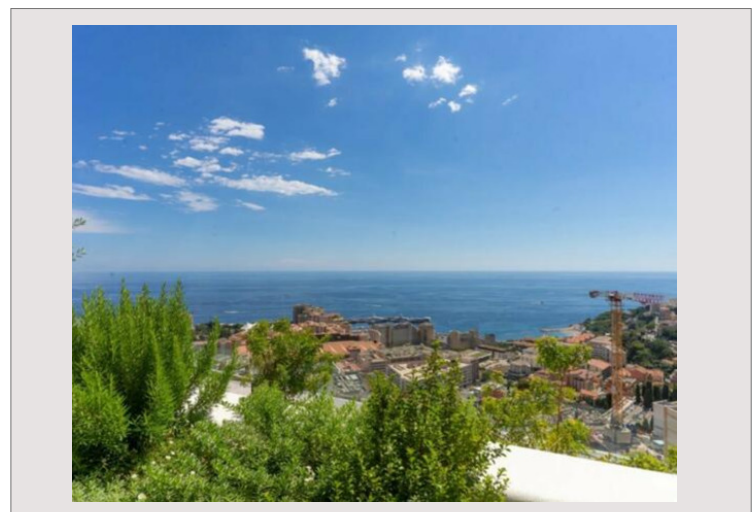
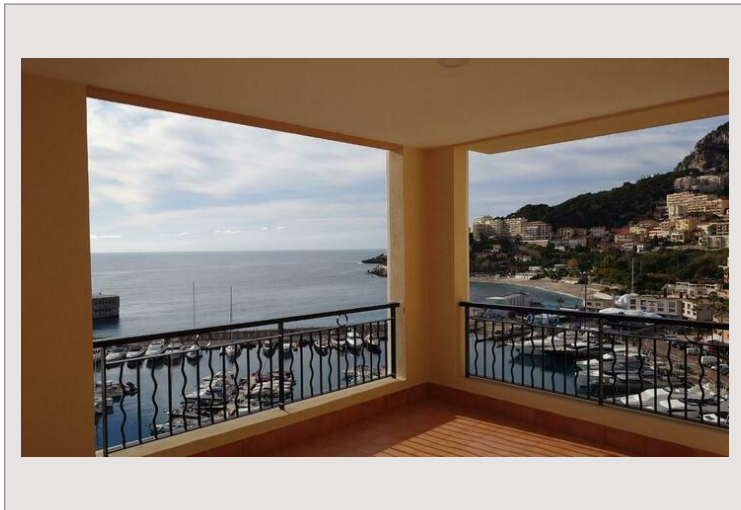
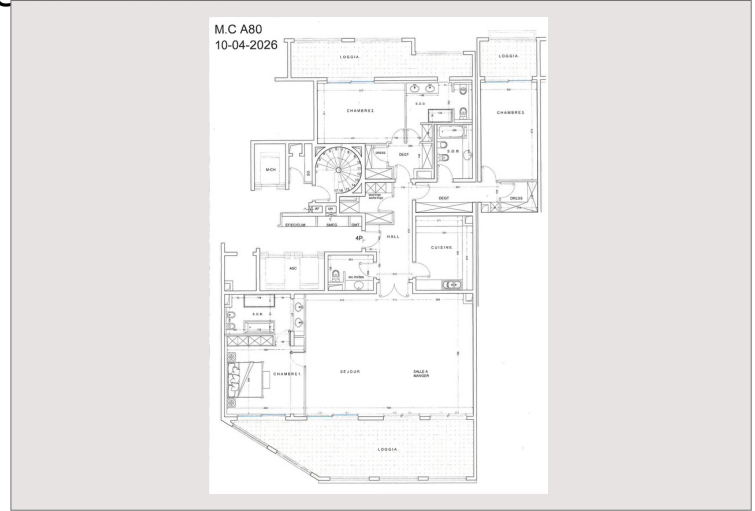
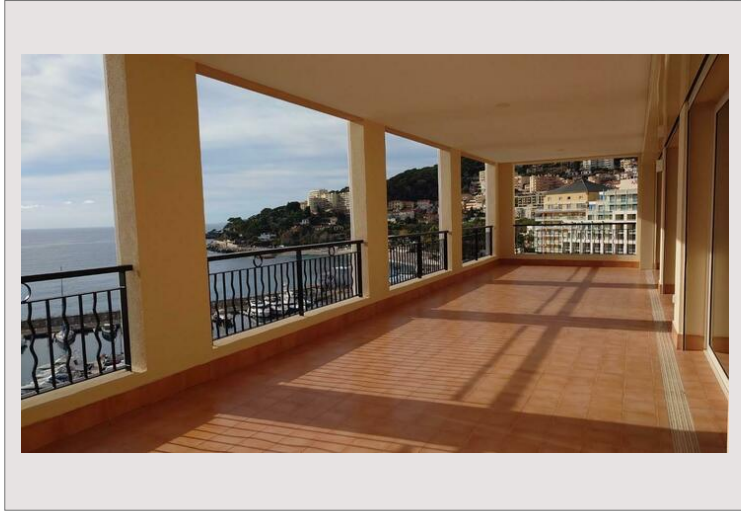

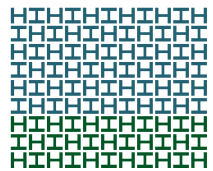

Fontvieille – Large family apartment with terrace, panoramic sea view, two parking spaces and cellar

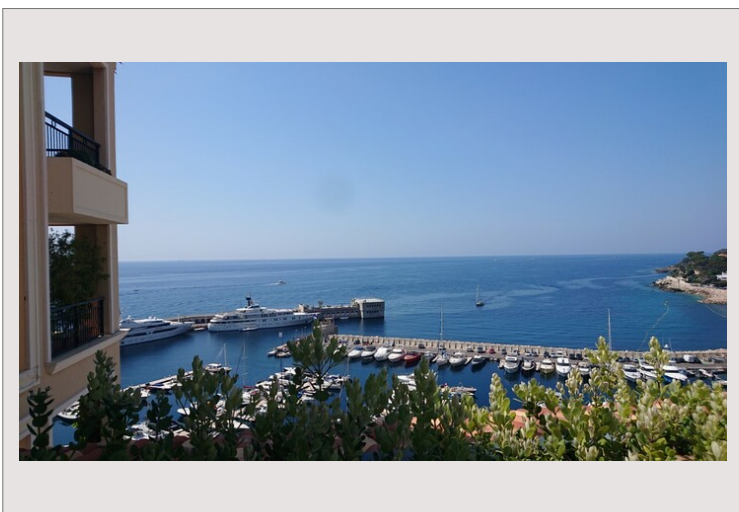
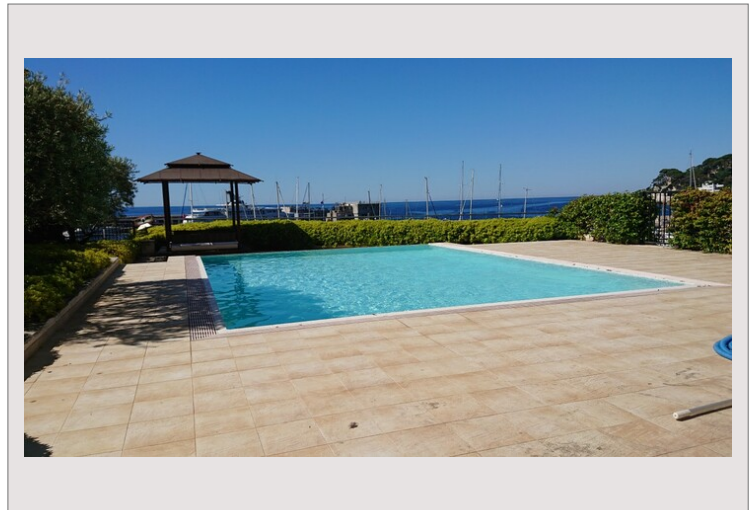
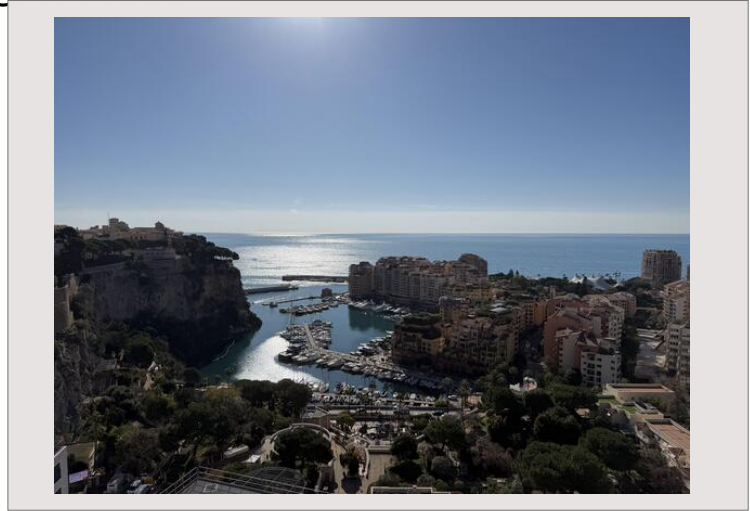
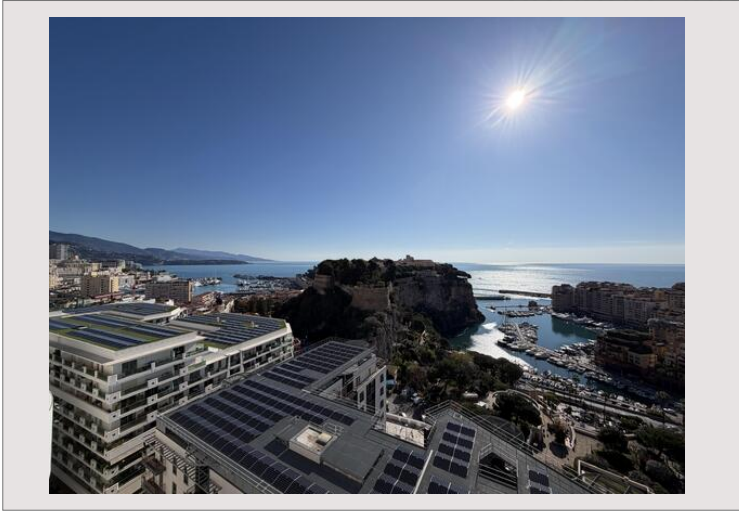

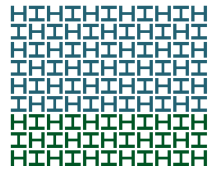

Fontvieille – Large family apartment with terrace, panoramic sea view, two parking spaces and cellar

